

## **ANEXOS**

*Manipulador robòtic con visió artificial (CableBot)*

Alberto López Germán

**Grado en Ingeniería Electrónica Industrial y Automática**

Tutor: Pere Martí Puig  
Vic, Septiembre de 2014

## Rundrohr-Verschlussstopfen Round tube stopper

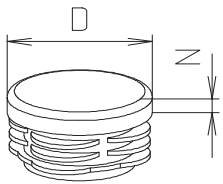

Polyäthylen schwarz black polyethylene

Code-No.	Type	Ø D	N
9.0301	18x1,5	18	5
9.0302	20x2	20	5
9.0303	25x2	25	5
9.0304	30x2	30	5
9.0305	32x3	30	5
9.0312	35x3	35	5
9.0306	40x3	40	5
9.0307	40x4	40	5
9.0308	45x4	45	5
9.0309	48x4	48	5
9.0310	50x4	50	5
9.0311	60x5	60	5
9.0313	50x3	50	5

Aluminium



Code-No.	Type	Ø D	N
9.0331	50x4	50	6
9.0332	60x5	60	6

## Vierkantrohr-Verschlussstopfen Square tube stopper

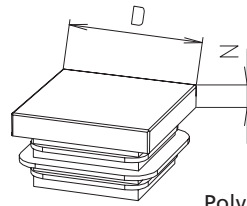

Polyäthylen schwarz black polyethylene

Code-No.	Type	□ D	N
9.0401	25x1,5	25x25	5
9.0402	30x2	30x30	5
9.0403	35x2,5	35x35	5
9.0404	40x3	40x40	5
9.0408	40x4	40x40	5
9.0405	50x3	50x50	5
9.0406	60x4	60x60	5
9.0407	80x5	80x80	5

Aluminium



Code-No.	Type	□ D	N
9.0411	50x3	50x50	6
9.0412	60x4	60x60	6

## Rundrohr-Gewindestopfen Round tube threaded stoppers

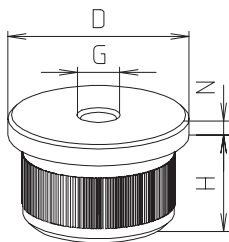

Aluminium

Code-No.	Type	D	G	H	N
9.0321	50x4	50	M10	25	6
9.0322	50x4	50	M16	25	6
9.0323	60x5	60	M10	30	6
9.0324	60x5	60	M16	30	6

## Vierkantrohr-Gewindestopfen Square tube threaded stoppers

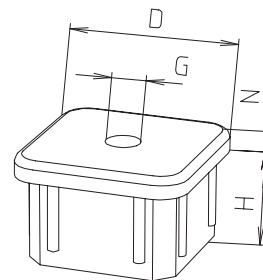

Aluminium

Code-No.	Type	D	G	H	N
9.0421	50x3	50x50	M10	25	6
9.0422	50x3	50x50	M16	25	6
9.0423	60x4	60x60	M10	30	6
9.0424	60x4	60x60	M16	30	6
9.0427	60x4	60x60	M10	25	8
9.0425	60x4	60x60	M16	25	8
9.0426	60x4	60x60	M20	25	8

NOTES

MATERIAL: -DIECAST ALUMINUM ALLOY,  
-FOUR 6-32 Philips screws

WATERPROOFING KIT AVAILABLE  
PART # 1590LBC  
THE GASKET KIT WILL AFFORD  
PROTECTION AGAINST LIQUID TO  
NEMA 4 AND IP65 LEVELS,

THIS ENCLOSURE IS ALSO  
AVAILABLE IN BLACK AND GRAY  
TEXTURE FINISH,

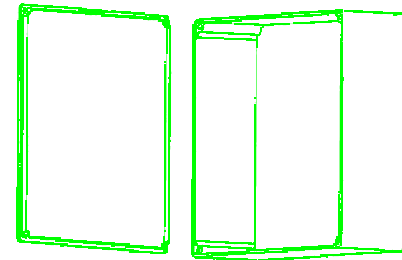
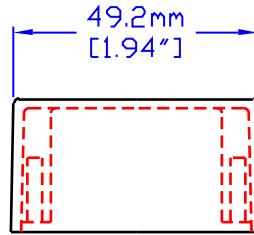

3D VIEW  
(NOT TO SCALE)

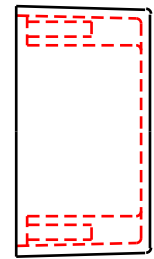
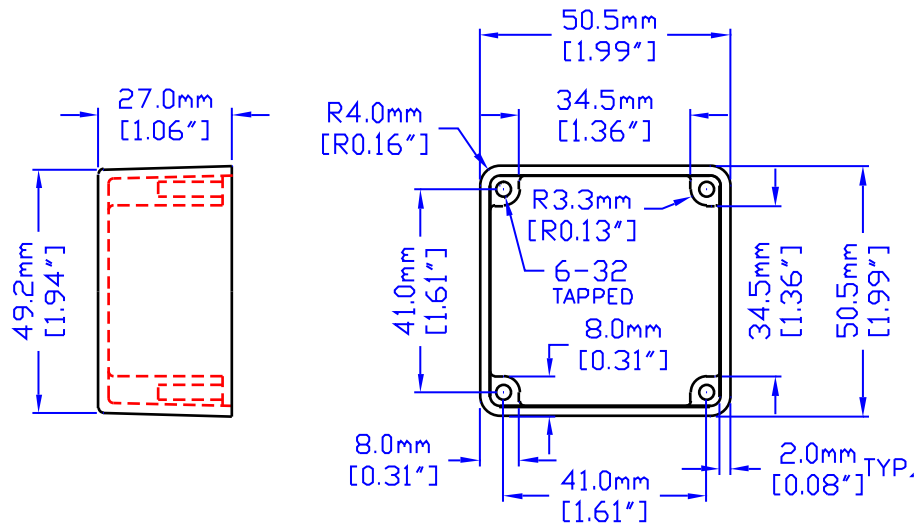

R4.0mm  
[R0.16"]

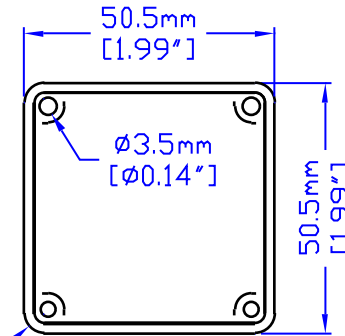

VIEW INSIDE LID

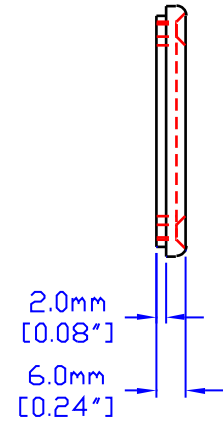

VIEW OF BOX (LID REMOVED)



HAMMOND MANUFACTURING

1590LB

CANADA - PH (519) 886 7170 - FAX (519) 886 8311  
U.S.A. - PH (716) 631 5700 - FAX (716) 631 1156



Sample photo

**Order symbol:** PCM 200/150 T  
**Product nbr:** 6016929  
**Description:** Enclosure, PC  
**Remarks:** Smoked transparent cover

**EAN:** 6418074038333  
**EI. number:**  
 Finland 3421678  
 Denmark 8212027394  
 Italy 7342080  
 Sweden 2535451

**Including:** Base with metric knock-outs and TPE gasket and screws for mounting plate/DIN-rail, cover with polyamide cover screws and wing heads for cover screws.

Dimensions:		L	W	H	Rating:
mm:		255	180	150	<b>Ingress Protection (EN 60529):</b> IP 66/67
inch:		10	7.1	5.9	<b>Impact Resistance (EN 50102):</b> IK 08
Materials:					
<b>Material:</b>		PC			
<b>Base colour:</b>		RAL 7035			
<b>Cover colour:</b>		Smoked grey			
<b>Cover screws material:</b>		Polyamide			
<b>Cover screws colour:</b>		Black			
<b>Gasket material:</b>		TPE			
Temperatures:					
<b>Short term:</b>		-40 ... 120 °C			
<b>Continuous:</b>		-40 ... 80 °C			
<b>Short term:</b>		-40 ... 250 °F			
<b>Continuous:</b>		-40 ... 175 °F			
Accessories:					
MIV 200		Mounting plate			
MIN 15		DIN-15 Mounting rail			
MIN 20		DIN-15 Mounting rail			
MIV 15		DIN-35 Mounting rail			
MIV 20		DIN-35 Mounting rail			
FP A 200/180		Front plate			
HFP 180		Front plate hinge series			
					<b>Electrical insulation:</b> Totally insulated
					<b>Halogen free (DIN/VDE 0472, Part 815):</b> Yes
					<b>UV resistance:</b> UL 508
					<b>Flammability Rating (UL 746 C 5):</b> UL 94 5V
					<b>Glow Wire Test (IEC 695-2-1) °C:</b> 960
					<b>NEMA Class:</b> NEMA 1, 4, 4X, 6, 12, 13
Certificates:					
		Germanischer Lloyd (GL)			
		Underwriters Laboratories			
		Det Norske Veritas			
		Fimko			
		Europe EN 50298 1998			
		UL Canada			
		Gost R			

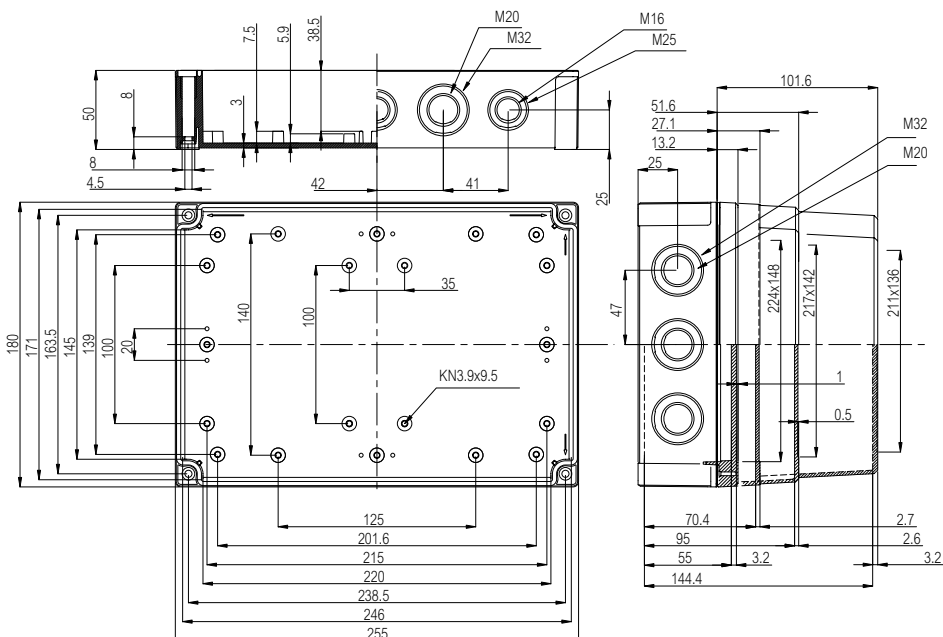

# BigEasyDriver v1.2

www.schmalzhaus.com/BigEasyDriver

An easy to use bipolar stepper motor driver  
 Use 4 wire, 6 wire or 8 wire stepper motors  
 From 0mA/phase to over 2A/phase  
 Defaults to 5V for Ucc (logic supply), settable to 3.3V  
 Supply 8V to 35V DC power input on JP1 or JP7  
 Do not connect or disconnect motor while BigEasyDriver is powered

DEFAULT OPTIONS  
 Short JP10, or JP6 pins to GND or Ucc to override  
 SLEEP = Ucc (awake)  
 MS1 = Ucc (1/16 microstep)  
 MS2 = Ucc (1/16 microstep)  
 ENABLE = GND (enabled)  
 RESET = Ucc (not reset)  
 MS3 = Ucc (1/16 microstep)

NOTE: UCC is normally an OUTPUT. You do not need to supply power to the Big Easy Driver through UCC. The only power needed is through M+ (motor power).

You only need to connect M+, GND, STEP, DIR and the motor outputs  
 All other I/O is set to default to 1/16th microstep mode

DIR is level sensitive  
 A rising edge on STEP causes a step  
 Both take 0V to Ucc

Bi-polar Stepper Motor Outputs  
 Coil A of motor across COILA+ and COILA-  
 Coil B of motor across COILB+ and COILB-

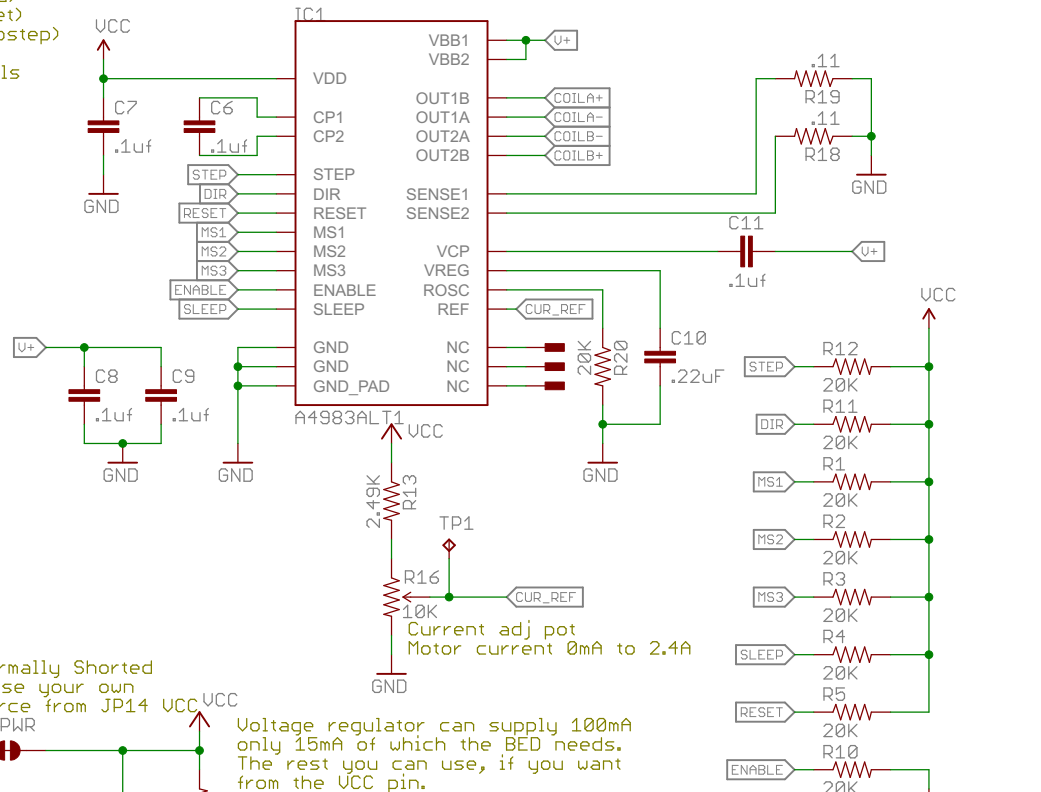
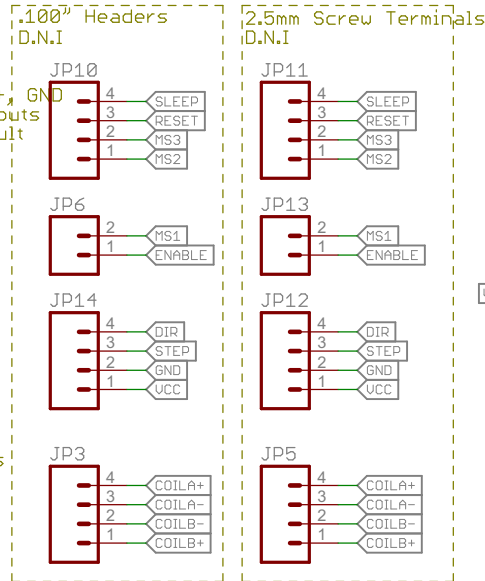

Power Input JP1, JP7  
 8V to 35V DC

APWR Normally Shorted  
 Must use LM317 Cut to use your own  
 For 35V U+ input Ucc source from JP14

Voltage regulator can supply 100mA only 15mA of which the BED needs. The rest you can use, if you want from the UCC pin.

BigEasyDriver v1.2 by Brian Schmalz is licensed under a Creative Commons Attribution 3.0 US License

Change List:  
 v1.0 Original version  
 v1.1 Added pull-ups, re-routed  
 v1.2 5/2/11 Silk screen corrections, sense resistors now .11 ohms  
 SparkFun design rules applied - minor layout tweaks, R13 now XXX

1/10/12 -v13- Changes:  
 -updated footprint for driver IC (1:1)  
 -ran all traces directly away from IC  
 -moved vias and retraced as necessary on UCC and GND TOP layers



Released under the Creative Commons Attribution Share-Alike 3.0 License <a href="http://creativecommons.org/licenses/by-sa/3.0">http://creativecommons.org/licenses/by-sa/3.0</a>	
TITLE: BigEasyDriver11876	SFE
Design by Brian Schmalz Revised by Patrick Alberts Produced by Spark Fun Electronics	REV: v15
Date: 8/2/2013 1:55:52 PM	Sheet: 1/1

## 增量型旋转编码器

增量型 外径 $\phi 25$  型号: A6A2  
INCREMENTAL ROTARY ENCODERS, OUTSIDE DIAM  $\phi 25$  MODEL: A6A2  
替代型号SUBSTITUTE: E6A2

### 型号 小型编码器MINITYPE ENCODERS

#### A6A2 - CWZ 6C

外径 $\phi 25$   
outside diam  $\phi 25$   
序列号  
Sequence Number

- B: PNP开路输出 PNP open collector Output
  - C: NPN开路输出 Open collector NPN output
  - E: 电压 (NPN) 输出 Voltage output
  - Gh: 互补输出 NPN Push Pull output
  - EH: 电压 (PNP) 输出 PNP Voltage output
  - 1: DC5V
  - 3: DC5~12V
  - 5: DC12~24V
  - 6: DC5~24V
  - Z: 带复位相输出 + Zero Signal
  - S: 单相输出 singleness Output "A"
  - W: 多相输出 AB90° Phase Difference
- 绝对式编码器 • • • • •
- 增量式编码器 • • • • •



### 种类 Ordering Information

#### ◆ 本体 ABSOLUTE ROTARY ENCODERS

输出相 Output Mode	电源电压 Supply Voltage	输出状态 Output Configuration	替代型号 Substitute	分辨率 (脉冲/旋转) Resolution (p/r)					
				10	60	100	200	300	360
A相	DC 5~12V	电压输出 Voltage output	型号A6A2-CS3E	10	60	100	200	300	360
		NPN开路集电极 输出 Open collector NPN output	型号A6A2-CS3C	10	60	100	200	300	360
	DC12~24V	电压输出 Voltage output	◎型号A6A2-CW3E	100	200	360			
		NPN开路集电极 输出 Open collector NPN output	◎型号A6A2-CW3C	100	200	360			
A相、B相 Z相	DC 5~12V	电压输出 Voltage output	◎型号A6A2-CWZ3E	100	200	360			
		NPN开路集电极 输出 Open collector NPN output	◎型号A6A2-CWZ3C	100	200	360			
	DC12~24V	电压输出 Voltage output	◎型号A6A2-CW5E	100	200	360			
		NPN开路集电极 输出 Open collector NPN output	◎型号A6A2-CW5C	100	200	360			

注: 订购时, 除型号之外, 还一定要指定“分辨率”。  
分辨率为标准在庫, 无记号的为接收订货生产。

- 适应定位的需要。  
带原点输出(Z相)型出现在生产线上。
- 也实现了更高精度的测长等。
- 追加了外径 $\phi 25$ , 分辨率500P/R的系列。

## 增量型旋转编码器

增量型 外径φ25 型号: A6A2  
INCREMENTAL ROTARY ENCODERS, OUTSIDE DIAM φ25 MODEL: A6A2  
替代型号SUBSTITUTE: E6A2

外径: φ25 型号: A6A2 替代型号: E6A2

Miniature Rotary Encoder for  
Positioning in Space-Confined Areas

- Wide variety of supply voltages and output forms to match input devices
- Models with zero index function ideal for positioning applications
- High resolution models (300 or 360 pulses per revolution) substantially improve measuring accuracy
- High response frequency and noise immunity make encoders ideal for factory automation applications



### ■ 额定/性能SPECIFICATIONS

型号MODEL	型号A6A2 -CS3E	型号A6A2 -CS3C	型号A6A2 -CS5C	型号A6A2 -CW3E	型号A6A2 -CW3C	型号A6A2 -CW5C	型号A6A2 -CWZ3E	型号A6A2 -CWZ3C	型号A6A2 -CWZ5C
电源电压 Powersupplyvoltage	DC5V-5%~12V+10% 脉动(p-p)5%以下		DC12V-10% ~24V+15% 脉动(p-p)5% 以下	DC5V-5%~12V+10% 脉动(p-p)5%以下		DC12V-10% ~24V+15% 脉动(p-p)5% 以下	DC5V-5%~12V+10% 脉动(p-p)5%以下		DC12V-10% ~24V+15% 脉动(p-p)5% 以下
消耗电流 Currentconsumption	30mA以下max		20mA以下max	30mA以下max		20mA以下max	50mA以下max		30mA以下max
分辨率(脉冲/旋转) Resolution(See Note 1)	10, 20, 60, 100, 200, 300, 360, 500					10, 200, 360, 500			
输出相 Output phases	A相			A相、B相			A相、B相、Z相		
输出状态 Output form	电压输出 Voltage output		开路集电极输出 Open collector output	电压输出 Voltage output		开路集电极输出 Open collector output	电压输出 Voltage output		开路集电极输出 Open collector output
输出容量 Output capacity	输出电阻: 2kΩ Output resistance: 2kΩ 输出电流: 20mA以下 Sink current: 20 mA max 残留电压: 0.4V以下 Residual voltage: 0.4 V max (输出电流)20mA时		外加电压: DC30V以下 Applied voltage: 30 VDC max 同步电流: 30mA以下 Sink current: 30 mA max 残留电压: 0.4V以下 (同步电流30mA以下) Residual voltage: 0.4 V max	输出电阻: 2kΩ Output resistance: 2kΩ 输出电流: 20mA以下 Sink current: 20 mA max 残留电压: 0.4V以下 Residual voltage: 0.4 V max (输出电流)20mA时		外加电压: DC30V以下 Applied voltage: 30 VDC max 同步电流: 30mA以下 Sink current: 30 mA max 残留电压: 0.4V以下 (同步电流30mA以下) Residual voltage: 0.4 V max	输出电阻: 2kΩ Output resistance: 2kΩ 输出电流: 20mA以下 Sink current: 20 mA max 残留电压: 0.4V以下 Residual voltage: 0.4 V max (输出电流)20mA时		外加电压: DC30V以下 Applied voltage: 30 VDC max 同步电流: 30mA以下 Sink current: 30 mA max 残留电压: 0.4V以下 (同步电流30mA以下) Residual voltage: 0.4 V max
最高应答频率 Maximum response frequency	30kHz								
输出相位差 Phase difference of output	A相、B相差 90° ±45°								
输出占空比 output wavetrom percentage	50±25%								
输出上升、下降时间 Output rise and fall times	1.0 μs以下 max 导线cable 500mm, 同步电流10mA (at sink current of mA with 2 m cable)		1.0 μs以下, 导线长500mm, 控制输出电压5V, 负载电阻1KΩ 1.0 μs max. (at control output voltage of 5 V and load resistance of 1 kΩ with 2 m cable)	1.0 μs以下 max 导线cable 500mm, 同步电流10mA (at sink current of mA with 2 m cable)		1.0 μs以下, 导线长500mm, 控制输出电压5V, 负载电阻1KΩ 1.0 μs max. (at control output voltage of 5 V and load resistance of 1 kΩ with 2 m cable)	1.0 μs以下 max 导线cable 500mm, 同步电流10mA (at sink current of 10 mA with 2 m cable)		1.0 μs以下, 导线长500mm, 控制输出电压5V, 负载电阻1KΩ 1.0 μs max. (at control output voltage of 5 V and load resistance of 1 kΩ with 2 m cable)

\*1 电的最高应答转速由分辨率以及最高应答频率决定。  
电的最高应答频率转速(r/min)=  $\frac{\text{最高响应频率}}{\text{分辨率}} \times 60$   
因此, 如果旋转超过最高响应转速, 则电气上无法追踪信号。  
\*2 对水、油没有保护作用。  
\*3 接通电源时, 会流过约9A的冲流。(时间约0.3ms)

Note:  
◆The maximum electrical response revolution is determined by the resolution and maximum response frequency as follows:  
◆Maximum electrical response frequency (rpm)  
= Maximum response frequency ÷ resolution × 60  
◆This means that the A6B2 encoder will not operate electrically if its shaft speed exceeds the maximum electrical response revolution.

## 增量型旋转编码器

增量型 外径 $\phi 25$  型号: A6A2  
 INCREMENTAL ROTARY ENCODERS, OUTSIDE DIAM  $\phi 25$  MODEL: A6A2  
 替代型号SUBSTITUTE: E6A2

**外径:  $\phi 25$  型号: A6A2 替代型号: E6A2**

### ■ 额定/性能SPECIFICATIONS

机械性能 参数 Mechanical Spec		
起动转矩 Startion Torque	1mN·m以下max	
惯性力矩Moment of Inertia	$1 \times 10^{-7}$ kg·m <sup>2</sup> 以下max	
允许容力 Shaft loading	倾向Radial	10N
	推力Thrust	5N
允许安装精度 Mounting Tolerance	侧面误差 Ra radial: 0.03mm TIR Max; 正向误差 Axial: 0.2mm Max; 角度误差 Shaft Runout: 0.1° Max	
轴最大负荷 Allowable Shaft Load	径向Radial: 5N, 轴向 Axial: 3N	
允许最高转速Maxirnun Rotating Speed	5000rpm	
环境温度 Operating Temp Range	工作时: -10 ~ +55℃ 保存时: -25 ~ +80℃ (不结冰)	
环境湿度Humidity	工作时、保存时: 各35 ~ 85%RH(不结露)	
绝缘电阻 Insulation resistance	20M $\Omega$ 以上(DC500V摇表)充电部整体与外壳间	
耐电压 Dielectric strength	AC500V 50/50Hz 1min 充电部整体与外壳间 充电部整体与外壳间	
振动(耐久)Vibration resistance	10~55Hz 上下振幅1.5mm X、Y、Z各方向	
冲击(耐久)Shock resistance	500m/s <sup>2</sup> X、Y、Z各方向 3次	
保护结构 Degree of protection	IEC规格 Ip50	
连接方式 Connection	导线引出型(标准导线长cable length: 500mm)	
质量 Weight	约60g	
附件 Accessories	耦合器、伺服装置用安装配件(附于型号E6A2-CW2口)、六角扳手, 使用说明书	

### ■ 外形尺寸Dimensions (单位Unit: mm)

#### ◆ 本体

型号model:A6A2

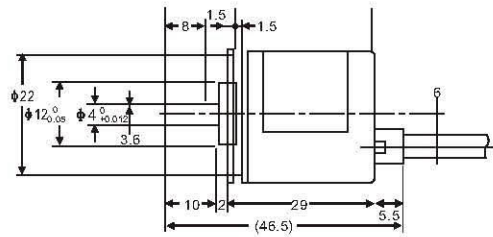
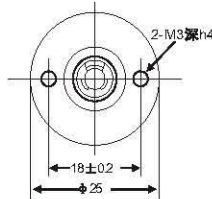

\*PVC绝缘圆形导线 $\phi 4.5$ 芯(导体截面积: 0.15mm<sup>2</sup>、绝缘体直径:  $\phi 0.9$ mm)标准500mm长

Output cable (shielded) O.D.: 4 dia.  
 Standard length: 50 cm (1.64 ft)



## 增量型旋转编码器

增量型 外径 $\phi 25$  型号: A6A2  
 INCREMENTAL ROTARY ENCODERS, OUTSIDE DIAM  $\phi 25$  MODEL: A6A2  
 替代型号SUBSTITUTE: E6A2

外径:  $\phi 25$  型号: A6A2 替代型号: E6A2

### 输出段回路图OUTPUT CIRCUIT DIAGRAMS

型号 MODEL	输出回路 Output diagram	输出方式 Output wave	连接 Wire Code												
型号A6A2-CS3C 型号A6A2-CS5C	<p>型号A6A2主回路</p> <p>棕Brown (Red) Vcc (+5~12V)              黑Black: A相, 白White: B相, 橙Orange: Z相              蓝Blue 0V</p> <p>DC 30V              30mA以下</p>	<p>输出晶体管Output transistor</p>	<table border="1"> <thead> <tr> <th>线色Wire color</th> <th>内容Signal</th> </tr> </thead> <tbody> <tr> <td>棕Brown</td> <td>+VCC</td> </tr> <tr> <td>黑Black</td> <td>A相ph</td> </tr> <tr> <td>白White</td> <td>B相ph</td> </tr> <tr> <td>橙Orange</td> <td>Z相ph</td> </tr> <tr> <td>蓝Blue</td> <td>0V</td> </tr> </tbody> </table>	线色Wire color	内容Signal	棕Brown	+VCC	黑Black	A相ph	白White	B相ph	橙Orange	Z相ph	蓝Blue	0V
线色Wire color		内容Signal													
棕Brown		+VCC													
黑Black	A相ph														
白White	B相ph														
橙Orange	Z相ph														
蓝Blue	0V														
型号A6A2-CW3C 型号A6A2-CW5C	<p>旋转方向: CW              Direction of rotation: CW              (从轴方向观察为右转)              Clockwise as viewed from the shaft</p> <p>输出晶体管</p>	<p>注: 1. 单型(型号A6A2-CS□□)中, 白和橙色无输出。(未连接)                  2. 换向型(型号A6A2-CW□□)中, 橙色无输出。(未连接)                  3. 电压输出型中, 可吸收20mA的电流。</p> <p>注1* (B) (L)表示电压输出型的状态。                  2. 顺时针(CW)旋转时, A相比B相, 超前<math>1/4T \pm 1/8T</math>相位。而逆时针(CCW)旋转时, A相比B相滞后<math>1/4T \pm 1/8T</math>相位。</p> <p>Note:</p> <ol style="list-style-type: none"> <li>The white (green) and orange (yellow) lines of the single type (E6A2-CS) do not output signals (no connection).</li> <li>The orange (yellow) line of the reversible type (E6A2-CW) does not output signal (no connection).</li> <li>The voltage output type is capable of sinking a maximum of 20 mA.</li> </ol> <p>Note:</p> <ol style="list-style-type: none"> <li>* (H) and (L) indicate the output levels of the voltage output type.</li> <li>Output A leads B by <math>1/4T \pm 1/8T</math> when the shaft revolves clockwise. Output lags behind B by <math>1/4T \pm 1/8T</math> when the shaft revolves counterclockwise.</li> </ol>													
型号A6A2-CWZ3C 型号A6A2-CWZ5C	<p>旋转方向: CCW              Direction of rotation: CCW              (从轴方向观察为右转)              Counterclockwise as viewed from the shaft</p> <p>输出晶体管</p>														
型号A6A2-CW3E	<p>输出晶体管</p>														
型号A6A2-CWZ3E	<p>型号A6A2主回路</p> <p>棕Brown Vcc (+5~12V)              黑Black: A相, 白White: B相              蓝Blue 0V</p> <p>20mA以下</p>	<p>旋转方向: CW              Direction of rotation: CW              (从轴方向观察为右转)              Clockwise as viewed from the shaft</p> <p>输出晶体管</p>	<p>Note:</p> <ol style="list-style-type: none"> <li>* (H) and (L) indicate the output levels of the voltage output type.</li> <li>Output A leads B by <math>1/4T \pm 1/8T</math> when the shaft revolves clockwise. Output lags behind B by <math>1/4T \pm 1/8T</math> when the shaft revolves counterclockwise.</li> </ol>												
型号A6A2-CS3E		<p>输出晶体管</p>													

### 安装尺寸 Installation Dimension (单位Unit: mm)

Dimensions with Encoder

Mounting Bracket E69-1  
 supplied with A6A2-CWZ encoders

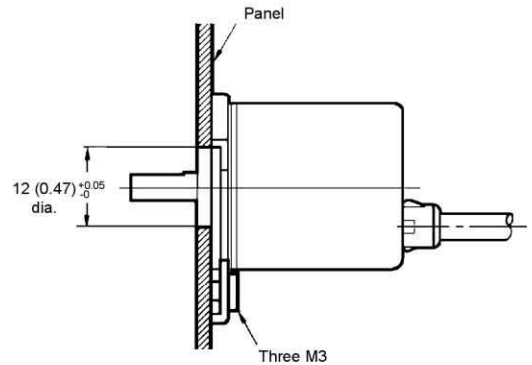
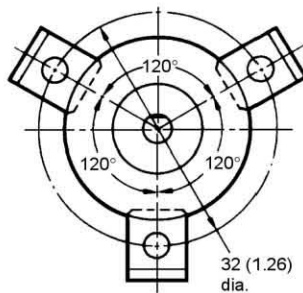
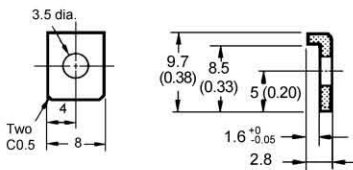

## 20x20 Gusset

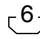
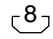

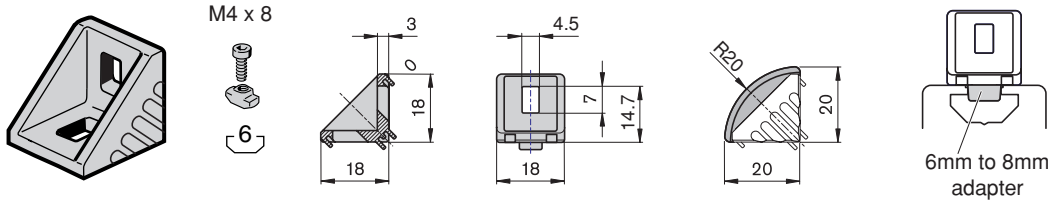



**Description**

**Qty**

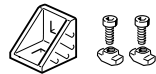
**Part Number**

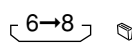
20x20 gusset only 	1	3 842 523 508
20x20 gusset with fasteners 	1	 3 842 523 511
20x20 round cover cap 	1	3 842 523 513
Plastic adapter 	1	3 842 523 516

## 20x40 Gusset

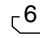
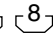

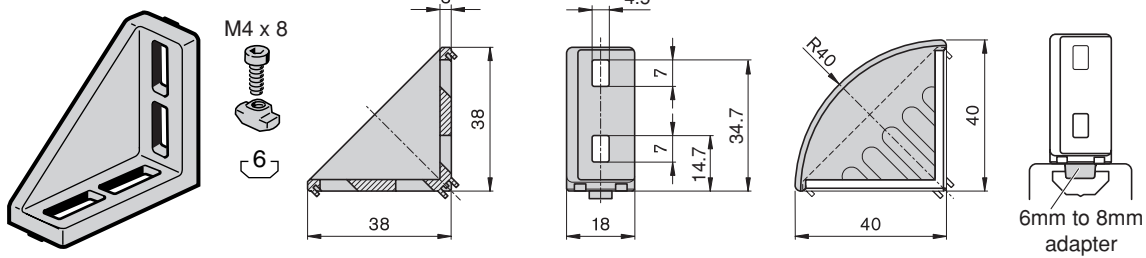



**Description**

**Qty**

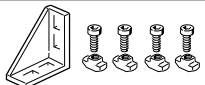
**Part Number**

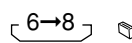
20x40 gusset only 	1	3 842 523 517
20x40 gusset with fasteners 	1	3 842 523 520
20x40 round cover cap 	1	3 842 523 522
Plastic adapter 	1	3 842 523 516



Seleccionar categoría

Todas las categorías

Buscar

Búsqueda avanzada

Volver a la portada | En la categoría: Cámaras y Fotografía &gt; Iluminación y estudio &gt; Otros



Pasa el puntero del ratón sobre la imagen para ampliarla

## Foco Antorcha Luz 76 LED 2.9W Difusor Filtro para Cámara Videocámara DSLR

Estado del artículo: **Nuevo**Cantidad: Más de 10 disponibles / **7 vendidos**Precio: **17,19 EUR****¡Cómpralo ya!**

11 usuarios siguiéndolo

[Añadir a lista de seguimiento](#)[Añadir a colección](#)[Añadir a lista de seguimiento](#)

## Información del vendedor

[jetjetshop \(37628\)](#)

98,6% Votos positivos

 [Seguir a este vendedor](#)[Ver otros artículos](#)Visitar tienda: [jetjetshop](#)

Registrado como vendedor Empresa

Envío gratuito

Vendedor con experiencia

Estado - nuevo

Envío: **GRATIS** Otros servicios | [Ver detalles](#)

Consulta los detalles acerca de los envíos internacionales aquí.

Ubicación del artículo: **Hong Kong, Hong Kong**Realiza envíos a: **Todo el mundo** [Ver exclusiones](#)Entrega: Prevista entre el **mar. 5 ago.** y el **vie. 22 ago.**Pagos: **PayPal** | [Ver información de pago](#)Devoluciones: reembolso de 14 días, comprador | [Ver detalles](#)Cobertura: **RECIBIDO O REEMBOLSADO** con **PayPal** [Ver condiciones](#)

AdChoice

¿Quieres vender uno? [Véndelo tú mismo](#)

Descripción

Envíos y pagos

[Imprimir](#)[Informar sobre un artículo](#)

Número de artículo de eBay : 331050697274

El vendedor asume toda la responsabilidad de este anuncio.

Última actualización el 29 jun 2014 04:59:46 H.Esp [Ver todas las actualizaciones](#)

## Características del artículo

Estado: Nuevo: Un artículo nuevo, sin usar, sin abrir, sin desperfectos y en el paquete original (en caso de venir ... [Más información](#)

EAN: 6913280953291

jetjetshop

[Visitar mi tienda eBay](#)[Suscribirse al boletín](#) [Artículos con descuento](#)

## Redomendación

Soporte Paraguas  
Flash giro 360 Grado  
**4,99 EUR**  
Envío gratisDifusor de Flash Caja  
para Nikon SB-600  
**2,49 EUR**  
Envío gratis1/4" Tornillo Screw  
Adaptador Cámara pa  
**1,89 EUR**  
Envío gratis3 en 1 Carta Tarjeta  
Digital Negro Blanco  
**6,69 EUR**  
Envío gratis

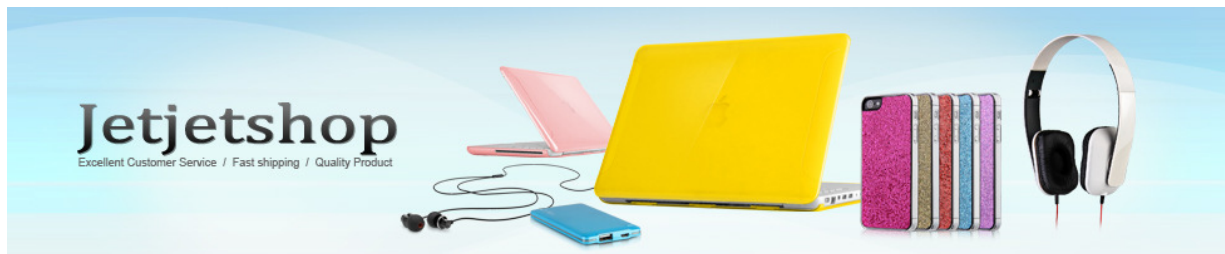

[Sobre pago](#)

[Envío y seguro](#)

[Voto](#)

[Sobre nosotros](#)

### Recientes Llegadas



Mando Disparador  
Intervalometro Apu  
**19,69 EUR**  
Envío gratis



Soporte Paraguas  
Flash giro 360 Gra  
**4,99 EUR**  
Envío gratis



Difusor Ventana de  
Flash Softbox  
**2,49 EUR**  
Envío gratis



Difusor de Flash C  
para Nikon SB-600

### Foco Antorcha Luz 76 LED 2.9W Difusor Filtro para Cámara Videocámara DSLR









#### **++ Descripción ++**

##### **Características:**

1. Diseño fino, volumen pequeño, peso ligero y portátil.
2. Adopta la tecnología LED y diseño de circuito de corriente constante para garantiza la luz de salida unánime, constante y precisa.
3. Proporciona fuente de luz perfecta con eficacia.

Nombre: NG Foco de Cámara

Modelo: CN-76

Color: negro

Tamaño: cerca de 109 x 107 x 52 mm

Tamaño del embalaje externo: unos 120 x 66 x 127 mm

Parámetros del equipo:

Energía: 2.9W

Voltaje de funcionamiento: 6V

Temperatura de color: 5400K-3200K

76 x Diodos Emisores de Luz

Modelo de la batería: 4 x 1,5 V pilas AA (baterías no incluidas)

Accesorios: 1 x LED luz de cámara, 1 x Difusor Filtro, 2 x Filtro de color, 1 x manual de usuario en inglés

Nota: Cuando no utiliza el producto, por favor, saque las pilas antes de guardarlo. Cuando la luz se debilita, por favor, cambie la batería a tiempo.

#### **Paquete contiene**

- 1 x foco para cámara
- 1 x difusor filtro
- 2 x filtro de color

1 x manual en inglés  
En paquete original

**++ Sobre pago ++**

**++ Envío y seguro ++**

**++ Voto ++**

**++ Sobre nosotros ++**

Aceptamos PayPal y transferencia bancaria.  
Debe pagar dentro de 5 días siguientes al terminar la subasta. Subastas ganadas pero no pagadas se reportarán a Ebay.

## Top vebtas



Soporte para Paraguas giratorio  
**3,99 EUR**  
Envío gratis



ADAPTADOR ROSCA TRIPODE 1/4\*20  
**1,69 EUR**  
Envío gratis



Difusor de Flash Caja para Nikon SB-600  
**2,49 EUR**  
Envío gratis



Difusor de Flash Caja para Yongnuo  
**2,29 EUR**  
Envío gratis



Base Pie Soporte de Flash Zapata para  
**2,09 EUR**  
Envío gratis



Mando Disparador Intervalometro Aputure  
**19,69 EUR**  
Envío gratis



Soporte Paraguas Flash giro 360 Grado  
**4,99 EUR**  
Envío gratis

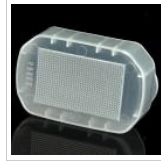

Difusor de Flash Caja Blanco para Cámara  
**2,39 EUR**  
Envío gratis



Lente Protección Cubierta Silicona  
**4,39 EUR**  
Envío gratis



1/4" Tornillo Screw Adaptador Cámara pa  
**1,89 EUR**  
Envío gratis

### Preguntas y respuestas sobre este artículo

No se ha publicado ninguna pregunta ni respuesta sobre este artículo.

[Preguntar al vendedor](#)

### Vínculos patrocinados

#### [Oferta Foco Exterior LED](#)

Desde sólo 12,95 € IVA Incl. Proyector LED de 10W

[www.efectoled.com/Focos+LED](http://www.efectoled.com/Focos+LED)

[Downlight LED](#)

[Bombillas y Lámparas LED](#)

[Placas LED SuperSlim](#)

[Tiras LED](#)

#### [Tienda Madrid M30 Ventas](#)

Nueva tienda exposición en Madrid Especializada en iluminación LED

[plus.google.com/](http://plus.google.com/)

#### [Luces de Led Baratas](#)

Tenemos el Mejor Precio de Internet Envíos desde España en 24/48 Horas.

[luces-led.tirasdeledbaratas.com/](http://luces-led.tirasdeledbaratas.com/)

[Kits Completos](#)

[Tiras de Led a Medida](#)

[Todo en Lamparas Led](#)

#### [CN 2400 Pro antorcha](#)

98€ IVA y envío incluido **Antorchas LED** Video y Foto

[www.americanphotoimp.com/Antorchas](http://www.americanphotoimp.com/Antorchas)

#### [Tu tienda Online de Leds](#)

Directo del Mayorista a tu Cliente El mejor Mayorista/Sin competencia

[www.tiendasenalquiler.es/](http://www.tiendasenalquiler.es/)



**ESTAMOS AQUÍ PARA AYUDARTE**

Contacta con nosotros

[Haz clic aquí ▶](#)

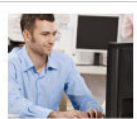

[Volver a la portada](#)

[Volver arriba](#)



---

[Acerca de eBay](#) [Prensa](#) [Publicidad](#) [Comprar](#) [Lista de deseos de eBay](#) [Registro](#) [Comisiones y tarifas](#) [Formas de pago a eBay](#) [Votos](#) [Empleo](#)

[Atención al Cliente](#) [Mapa del sitio](#)

Copyright © 1995-2014 Todos los derechos reservados. Las marcas comerciales y las marcas mencionadas son propiedad de sus propietarios correspondientes. El uso de este sitio Web implica la aceptación de las [Condiciones de uso](#), [privacidad](#) y [cookies](#) de eBay.

[Hora oficial de eBay](#)

[\(es-es/home\)](#)
[Accesorios para ordenador](#)
[Móvil](#)
[Hogar digital](#)
[Productos para juegos](#)
[Música](#)
[Business](#)
[CÁMERA](#)
[Asistencia](#)
[MI CUENTA](#)

[Ver todo Cámaras Web » \(/webcam-communications/webcams\)](#)

## Logitech HD Webcam C525

[Introducción](#)
[Funciones](#)
[Otras vistas](#)
[Especificaciones](#)
**EUR 51.90**
[Asistencia \(/es-es/support/webcams/hd-webcam-c525\)](#)
**+ Envío gratuito**

Videoconferencias y grabaciones en alta definición en cualquier parte: con enfoque automático.



### Videoconferencias HD 720p

Con vídeo HD (720p) en pantalla panorámica en la mayoría de aplicaciones de mensajería instantánea compatibles con videoconferencias HD.



### Acérquese más con enfoque automático

Disfrutará de videoconferencias nítidas incluso en primerísimos planos (hasta 7 cm).

### Va dondequiera que vaya usted

Cabe en un bolso y hasta en algunos bolsillos: con su diseño plegable, esta cámara Web se puede llevar a todas partes.

[Nosotros \(/es-es/about\)](#)
[Inversores \(http://ir.logitech.com\)](#)
[Prensa \(/es-es/press\)](#)
[Contactar \(/es-es/contact\)](#)
[Blog \(http://blog.logitech.com\)](#)
[Empleo \(http://careers.logitech.com\)](#)
[Seguridad y protección de datos \(/es-es/footer/privacy\)](#)
[Administración de suscripciones \(/es-es/footer/subscription-management\)](#)
[Términos de uso \(/es-es/footer/terms-of-use\)](#)
[mapa del sitio \(/es-es/utilities/sitemap\)](#)
[Ofertas Especiales \(/special-offers#\)](#)

### Conecte con nosotros

[Compartir](#)
**33**
[Facebook](#)
**33**
[Twitter](#)
**0**

[Cambiar ubicación \(/es-es/change-location/?returnurl=cHJvZHVjdC9oZC13ZWJyW0tYzUyNSszNCs3Nzk0\)](#)

<https://www.facebook.com/Logitech.ES>

[https://twitter.com/logitech\\_es](https://twitter.com/logitech_es)

© 2014 Logitech. Reservados todos los derechos

Este sitio usa cookies. Para continuar sin cambiar su configuración, acepta el uso de cookies. Más información. (<http://www.logitech.com/promotions/cookie-compliance>)



### Features

- STM32 microcontroller with LQFP64 package
- Two types of extension resources
  - Arduino Uno Revision 3 connectivity
  - STMicroelectronics Morpho extension pin headers for full access to all STM32 I/Os
- mbed-enabled (*mbed.org*)
- On-board ST-LINK/V2-1 debugger/programmer with SWD connector
  - selection-mode switch to use the kit as a standalone ST-LINK/V2-1
- Flexible board power supply
  - USB VBUS or external source (3.3 V, 5 V, 7 - 12 V)
  - Power management access point
- Three LEDs
  - USB communication (LD1), user LED (LD2), power LED (LD3)
- Two push buttons: USER and RESET
- USB re-enumeration capability: three different interfaces supported on USB
  - Virtual Com port
  - Mass storage
  - Debug port
- Comprehensive free software HAL library including a variety of software examples
- Supported by wide choice of Integrated Development Environments (IDEs) including IAR, Keil, GCC-based IDEs

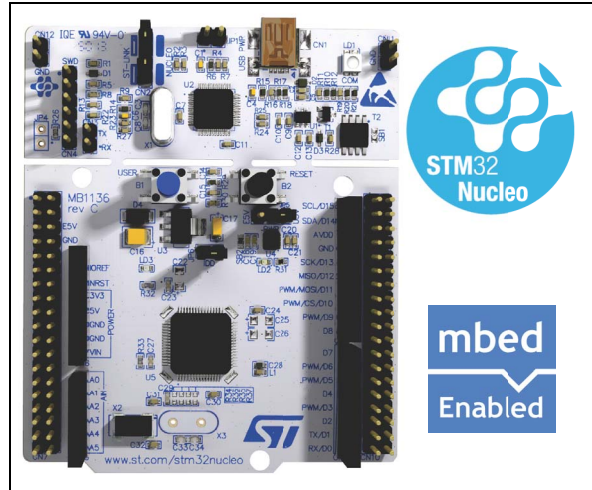

### Description

The STM32 Nucleo board provides an affordable and flexible way for users to try out new ideas and build prototypes with any STM32 microcontroller line, choosing from the various combinations of performance, power consumption and features. The Arduino™ connectivity support and ST Morpho headers make it easy to expand the functionality of the STM32 Nucleo open development platform with a wide choice of specialized shields.

The STM32 Nucleo board does not require any separate probe as it integrates the ST-LINK/V2-1 debugger/programmer.

The STM32 Nucleo board comes with the STM32 comprehensive software HAL library together with various packaged software examples, as well as direct access to mbed online resources.

**Table 1. Device summary**

Reference	Part number
NUCLEO-XXXXRX	NUCLEO-F030R8, NUCLEO-F072RB NUCLEO-F103RB NUCLEO-F302R8 NUCLEO-F334R8 NUCLEO-F401RE, NUCLEO-F411RE NUCLEO-L053R8, NUCLEO-L152RE

# 1 Ordering information

[Table 2](#) lists the order codes and the respective targeted MCU.

**Table 2. Ordering information**

Order code	Targeted MCU
NUCLEO-F030R8	STM32F030R8T6
NUCLEO-F072RB	STM32F072RBT6
NUCLEO-F103RB	STM32F103RBT6
NUCLEO-F302R8	STM32F302R8T6
NUCLEO-F334R8	STM32F334R8T6
NUCLEO-F401RE	STM32F401RET6
NUCLEO-F411RE	STM32F411RET6
NUCLEO-L053R8	STM32L053R8T6
NUCLEO-L152RE	STM32L152RET6

The meaning of NUCLEO-TXXXRY codification is as follows:

- TXXX describes the STM32 MCU product line
- R describes the pin count (R for 64 pins)
- Y describes the code size (8 for 64K, B for 128K, E for 512K)

The order code is printed on a sticker placed at the top or bottom side of the board.

# 2 Revision history

**Table 3. Document revision history**

Date	Revision	Changes
10-Feb-2014	1	Initial release.
13-Feb-2014	2	Added <a href="#">Table 1: Device summary</a> and updated <a href="#">Table 2: Ordering information</a> .
11-Apr-2014	3	Extended the applicability to NUCLEO-F302R8. Updated <a href="#">Table 1: Device summary</a> and <a href="#">Table 2: Ordering information</a> .
26-May-2014	4	Extended the applicability to NUCLEO-L053R8, NUCLEO-F072RB, NUCLEO-F334R8 and NUCLEO-F411RE Updated <a href="#">Table 1</a> and <a href="#">Table 2</a> .

**Please Read Carefully:**

Information in this document is provided solely in connection with ST products. STMicroelectronics NV and its subsidiaries ("ST") reserve the right to make changes, corrections, modifications or improvements, to this document, and the products and services described herein at any time, without notice.

All ST products are sold pursuant to ST's terms and conditions of sale.

Purchasers are solely responsible for the choice, selection and use of the ST products and services described herein, and ST assumes no liability whatsoever relating to the choice, selection or use of the ST products and services described herein.

No license, express or implied, by estoppel or otherwise, to any intellectual property rights is granted under this document. If any part of this document refers to any third party products or services it shall not be deemed a license grant by ST for the use of such third party products or services, or any intellectual property contained therein or considered as a warranty covering the use in any manner whatsoever of such third party products or services or any intellectual property contained therein.

**UNLESS OTHERWISE SET FORTH IN ST'S TERMS AND CONDITIONS OF SALE ST DISCLAIMS ANY EXPRESS OR IMPLIED WARRANTY WITH RESPECT TO THE USE AND/OR SALE OF ST PRODUCTS INCLUDING WITHOUT LIMITATION IMPLIED WARRANTIES OF MERCHANTABILITY, FITNESS FOR A PARTICULAR PURPOSE (AND THEIR EQUIVALENTS UNDER THE LAWS OF ANY JURISDICTION), OR INFRINGEMENT OF ANY PATENT, COPYRIGHT OR OTHER INTELLECTUAL PROPERTY RIGHT.**

**ST PRODUCTS ARE NOT DESIGNED OR AUTHORIZED FOR USE IN: (A) SAFETY CRITICAL APPLICATIONS SUCH AS LIFE SUPPORTING, ACTIVE IMPLANTED DEVICES OR SYSTEMS WITH PRODUCT FUNCTIONAL SAFETY REQUIREMENTS; (B) AERONAUTIC APPLICATIONS; (C) AUTOMOTIVE APPLICATIONS OR ENVIRONMENTS, AND/OR (D) AEROSPACE APPLICATIONS OR ENVIRONMENTS. WHERE ST PRODUCTS ARE NOT DESIGNED FOR SUCH USE, THE PURCHASER SHALL USE PRODUCTS AT PURCHASER'S SOLE RISK, EVEN IF ST HAS BEEN INFORMED IN WRITING OF SUCH USAGE, UNLESS A PRODUCT IS EXPRESSLY DESIGNATED BY ST AS BEING INTENDED FOR "AUTOMOTIVE, AUTOMOTIVE SAFETY OR MEDICAL" INDUSTRY DOMAINS ACCORDING TO ST PRODUCT DESIGN SPECIFICATIONS. PRODUCTS FORMALLY ESCC, QML OR JAN QUALIFIED ARE DEEMED SUITABLE FOR USE IN AEROSPACE BY THE CORRESPONDING GOVERNMENTAL AGENCY.**

Resale of ST products with provisions different from the statements and/or technical features set forth in this document shall immediately void any warranty granted by ST for the ST product or service described herein and shall not create or extend in any manner whatsoever, any liability of ST.

ST and the ST logo are trademarks or registered trademarks of ST in various countries.

Information in this document supersedes and replaces all information previously supplied.

The ST logo is a registered trademark of STMicroelectronics. All other names are the property of their respective owners.

© 2014 STMicroelectronics - All rights reserved

STMicroelectronics group of companies

Australia - Belgium - Brazil - Canada - China - Czech Republic - Finland - France - Germany - Hong Kong - India - Israel - Italy - Japan - Malaysia - Malta - Morocco - Philippines - Singapore - Spain - Sweden - Switzerland - United Kingdom - United States of America

[www.st.com](http://www.st.com)



## Hybrid Stepping Motor 42BYGHM

Product No.: N2007824174323

### General Specifications

Step Accuracy.....±5%  
 Temperature Rise.....80°C Max  
 Ambient Temperature Range.....-20°~+50°  
 Insulation Resistance.....100MΩ Min 500VDC  
 Dielectric Strength.....500VAC 1 Minute



### Electrical Specifications

42BYGHM 809	0.9	46	2.8	1.7	1.65	4	4200	4	68	220	0.34
----------------	-----	----	-----	-----	------	---	------	---	----	-----	------

### Mechanical Dimensions(外型图)

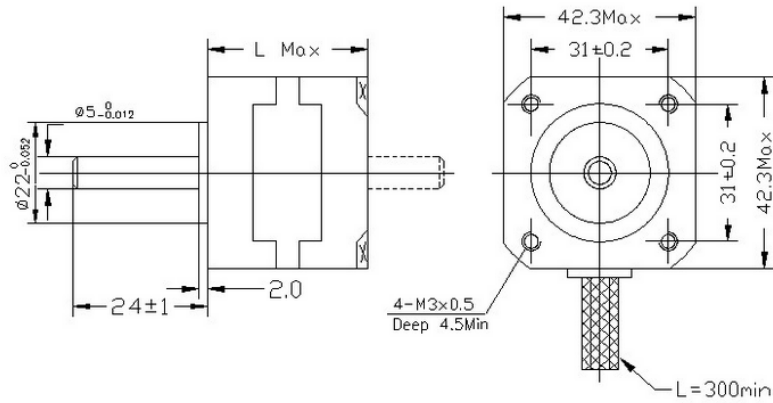

### Wiring diagram (接线图):

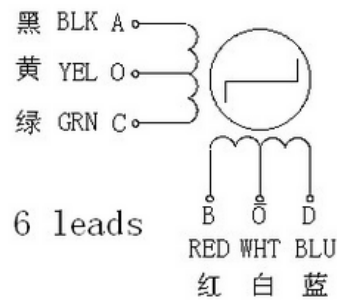
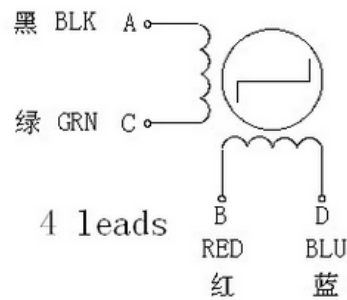

stepper motor / stepping motor / step motor / cnc router / motor control / stepper motor driver

Changzhou WanTai Electrical Appliance Co.,Ltd. Copyright All Rights Reserved. ICP07508477  
 provide High quality stepper motor,stepping gearmotor wholesale,stepping motor supplier

# Product Specification

## A040/ ... Plastic Base / Mild Steel Plated Stud Levelling Foot Range

**Materials ...** Base -Polyamide Reinforced Nylon  
Stud - Mild Steel, Plated

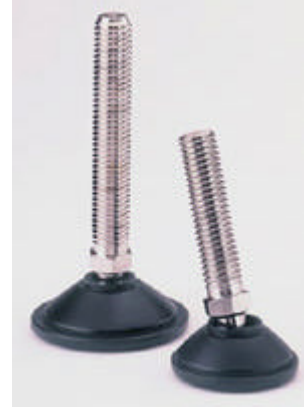

Part No.	Thread Size D1 (mm)	Thread Length L (mm)	Base Diameter D2 (mm)	Overall Height H (mm)	Max Load (kg)
A040 / 001	M6	20	40	41	300
A040 / 009	M6	20	50	43	300
A040 / 002	M6	40	40	61	300
A040 / 010	M6	40	50	63	300
A040 / 003	M8	25	40	46	450
A040 / 011	M8	25	50	48	450
A040 / 004	M8	40	40	61	450
A040 / 012	M8	40	50	63	450
A040 / 005	M8	60	40	81	450
A040 / 013	M8	60	50	83	450
A040 / 006	M10	38	40	59	500
A040 / 014	M10	38	50	61	500
A040 / 017	M10	60	40	81	500
A040 / 015	M10	60	50	83	500
A040 / 008	M10	75	40	96	500
A040 / 016	M10	75	50	98	500
A040 / 021	M12	50	40	76	600
A040 / 017	M12	50	50	75	600
A040 / 022	M12	75	40	98	600
A040 / 018	M12	75	50	100	600
A040 / 023	M12	100	40	123	600
A040 / 019	M12	100	50	125	600
A040 / 024	M12	125	40	148	600
A040 / 020	M12	125	50	150	600

Dimensions are approximate

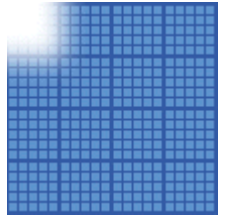
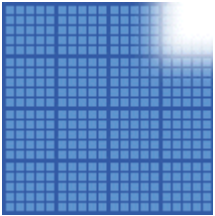
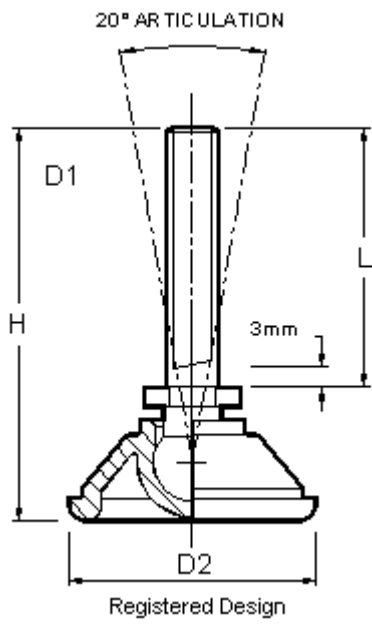





## Profile 8 40x40 light

RS Article no.: 7613319, 7613313 & 7613322

**Profile:** 40mm x 40mm  
**Groove size:** 8mm  
**Profile Length:** 1000mm, 2000mm & 3000mm  
**No. of grooves:** 4  
**Material:** Anodized Aluminium

item number	M ATP I8 4040L		
Moment of inertia	$I_x$	9.18	cm <sup>4</sup>
	$I_y$	9.18	cm <sup>4</sup>
Section modulus	$W_x$	4.59	cm <sup>3</sup>
	$W_y$	4.59	cm <sup>3</sup>
Mass	G	1.5	kg/m
Profile Surface	A	6.49	cm <sup>2</sup>
Profile groove		8	mm
Length	L	6060	mm
Packing Unit	PU	16	pcs.

Technical data strut profiles	
EN AW - 6063	DIN EN 573
Tolerance	DIN EN 12020-2
Anodizing	E6EV1
Thickness	15µm

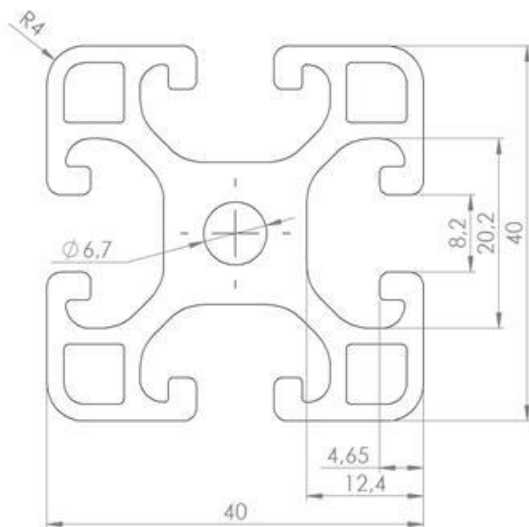

RS Article no.	40 Character Description	Profile Length
7613319	Profile 8 40x40 light 1m	1000mm
7613313	Profile 8 40x40 light 2m	2000mm
7613322	Profile 8 40x40 light 3m	3000mm

## Main

Range of product	Phaseo
Product or component type	Power supply
Power supply type	Regulated switch mode
Input voltage	100...240 V AC phase to phase, terminal(s): L1-L2 100...240 V AC single phase, terminal(s): N-L1 110...220 V DC
Output voltage	24 V DC
Rated power in W	72 W
Input protection type	Integrated fuse (not interchangeable)
Power supply output current	3 A
Output protection type	Against overload, protection technology: 1.1 x I <sub>n</sub> Against overvoltage, protection technology: tripping if U > 1.5 x U <sub>n</sub> Against short-circuits, protection technology: automatic reset Against undervoltage, protection technology: tripping if U < 0.8 x U <sub>n</sub>
Ambient air temperature for operation	0...60 °C without derating

## Complementary

Input voltage limits	100...250 V 85...264 V
Network frequency	47...63 Hz
Inrush current	<= 30 A
Cos phi	0.65
Efficiency	> 85 %
Output voltage limits	100...120 % adjustable
Power dissipation in W	12.7 W
Current consumption	0.83 A at 240 V 1.46 A at 100 V
Line and load regulation	+/- 3 %
Residual ripple	<= 200 mV
Holding time	>= 10 ms at 100 V >= 10 ms at 240 V
Connections - terminals	Screw type terminals for input connection, connection capacity: 2 x 0.14...2 x 2.5 mm <sup>2</sup> AWG gauge26...14 Screw type terminals for input ground connection, connection capacity: 1 x 0.14...1 x 2.5 mm <sup>2</sup> AWG gauge26...14 Screw type terminals for output connection, connection capacity: 2 x 0.14...2 x 2.5 mm <sup>2</sup> AWG gauge26...14 Screw type terminals for output ground connection, connection capacity: 1 x 0.14...1 x 2.5 mm <sup>2</sup> AWG gauge26...14
Marking	CE
Mounting support	35 x 15 mm symmetrical DIN rail 35 x 7.5 mm symmetrical DIN rail 75 x 7.5 mm symmetrical DIN rail
Operating position	Vertical
Output coupling	Parallel Series

The information provided in this documentation contains general descriptions and/or technical characteristics of the performance of the products contained herein. This documentation is not intended as a substitute for and is not to be used for determining suitability or reliability of these products for specific user applications. It is the duty of any such user or integrator to perform the appropriate and complete risk analysis, evaluation and testing of the products with respect to the relevant specific application or use thereof. Neither Schneider Electric Industries SAS nor any of its affiliates or subsidiaries shall be responsible or liable for misuse of the information contained herein.

Name of test	Conducted/Radiated emissions conforming to EN 55011 Conducted/Radiated emissions conforming to EN 55022 Class B Electrostatic discharges conforming to EN/IEC 61000-4-2 Emission conforming to EN 50081-1 Induced electromagnetic field conforming to EN/IEC 61000-4-6 Primary outage conforming to IEC 61000-4-11 Radiated electromagnetic field conforming to EN/IEC 61000-4-3 Rapid transient conforming to IEC 61000-4-4 Surge conforming to EN/IEC 61000-4-5
Status LED	1 LED green for output voltage 1 LED orange for input voltage
Product weight	0.52 kg

## Environment

Product certifications	CCSAus CSA 22-2 No 950-1 C-Tick CULus 508 TUV 60950-1
Environmental characteristic	EMC conforming to EN 50081-1 EMC conforming to EN 50082-2 EMC conforming to EN/IEC 61000-6-2 Safety conforming to EN/IEC 60950 Safety conforming to SELV
IP degree of protection	IP20 conforming to EN/IEC 60529
Ambient air temperature for storage	-25...70 °C
Relative humidity	0...95 % without condensation or dripping water
Class of protection against electric shock	Class I conforming to VDE 0106-1
Dielectric strength	3000 V between input and ground 3000 V between input and output 500 V between output and ground 500 V between outputs
RoHS EUR status	Compliant
RoHS EUR conformity date	0501

---

Regulated Switch Mode Power Supply

---

Dimensions and Mounting

Mounting on a 35 mm/1.37 in. or 75 mm/2.95 in. Rail

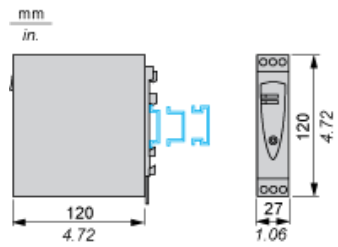

Regulated Switch Mode Power Supply

Internal Wiring Diagram

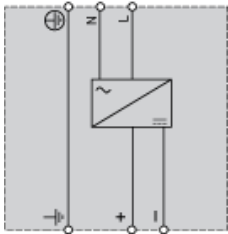

Regulated Switch Mode Power Supplies

Series or Parallel Connection

Series Connection

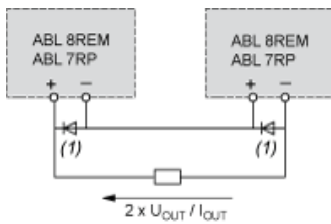

(1) Two Schottky diodes  $I_{min}$  = power supply  $I_n$  and  $V_{min}$  = 50 V

Parallel Connection

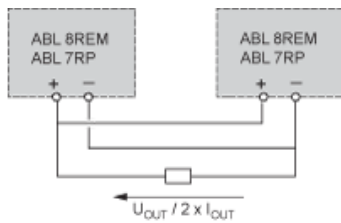

Family	Series	Parallel
ABL 8REM/7RP	2 products max.	2 products max.

Series or parallel connection is only recommended for products with identical references.

Regulated Switch Mode Power Supplies

Derating

The ambient temperature is a determining factor that limits the power an electronic power supply can deliver continuously. If the temperature around the electronic components is too high, their life will be significantly reduced.

The nominal ambient temperature for the Optimum range of Phaseo power supplies is 50 °C. Above this temperature, derating is necessary up to a maximum temperature of 60 °C.

The graph below shows the power as a percentage of the nominal power that the power supply can deliver continuously, depending on the ambient temperature.

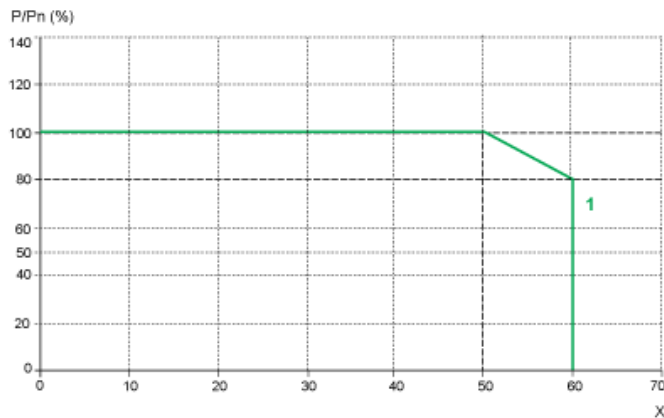

X Maximum operating temperature (°C)  
(1) ABL 8REM, ABL 7RP mounted vertically

Derating should be considered in extreme operating conditions:

- Intensive operation (output current permanently close to the nominal current, combined with a high ambient temperature)
- Output voltage set above 24 Vdc (to compensate for line voltage drops, for example)
- Parallel connection to increase the total power

Regulated Switch Mode Power Supply

Load Limit

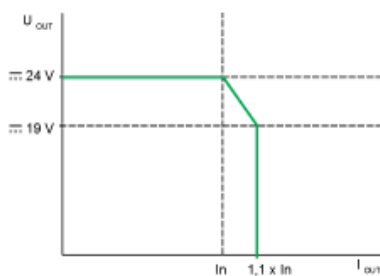

Regulated Switch Mode Power Supply

Temporary Overloads

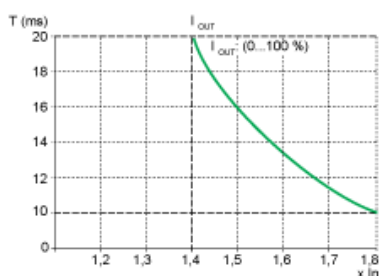

# BALL & SOCKET JOINTS

Manufactured to DIN 71802, these ball & socket joints feature induction hardened balls to resist wear. Security clips retain the threaded ball studs in their sockets and spanner flats are provided on the stud. Spanner flats can be provided on the sockets to order. Available in mild steel - zinc plated and clear passivated or in stainless steel, from stock.

Maximum static push/pull values are valid for both radial and axial loads but do not apply to stainless steel versions.

Supplied with appropriate lock nut.

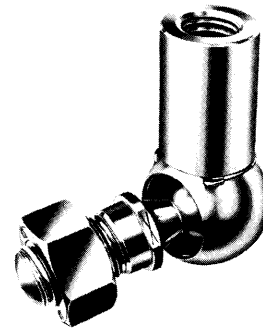

Order Code	Material	Thread	Size	Ball Ø		D4	L1	L2	L3	L4	L5	L6	R	Spanner flats A/F	Max static push/pull (kp)
				d1	d2										
373.05.C	Mild Steel	RH	5	8	M5	8	28.5	22	10.5	25.0	10.2	9	6.4	7	30
373.06.C	Mild Steel	RH	6	10	M6	10	32.5	25	11.5	30.0	12.5	11	7.5	8	70
373.08.C	Mild Steel	RH	8	13	M8	13	39.5	30	14.0	38.0	16.5	13	9.7	11	150
373.10.C	Mild Steel	RH	10	16	M10	16	47.0	35	15.5	47.5	20.0	16	12.0	13	200
373.12.C	Mild Steel	RH	12	16	M12	16	47.0	35	15.5	47.5	20.0	16	12.0	13	200
374.05.C	Mild Steel	LH	5	8	M5	8	28.5	22	10.5	25.0	10.2	9	6.4	7	30
374.06.C	Mild Steel	LH	6	10	M6	10	32.5	25	11.5	30.0	12.5	11	7.5	8	70
374.08.C	Mild Steel	LH	8	13	M8	13	39.5	30	14.0	38.0	16.5	13	9.7	11	150
374.10.C	Mild Steel	LH	10	16	M10	16	47.0	35	15.5	47.5	20.0	16	12.0	13	200
374.12.C	Mild Steel	LH	12	16	M12	16	47.0	35	15.5	47.5	20.0	16	12.0	13	200
373.05.C.S	Stainless Steel	RH	5	8	M5	8	28.5	22	10.5	25.0	10.2	9	6.4	-	-
373.06.C.S	Stainless Steel	RH	6	10	M6	10	32.5	25	11.5	30.0	12.5	11	7.5	-	-
373.08.C.S	Stainless Steel	RH	8	13	M8	13	39.5	30	14.0	38.0	16.5	13	9.7	-	-
373.10.C.S	Stainless Steel	RH	10	16	M10	16	47.0	35	15.5	47.5	20.0	16	12.0	-	-
373.12.C.S	Stainless Steel	RH	12	16	M12	16	47.0	35	15.5	47.5	20.0	16	12.0	-	-
374.05.C.S	Stainless Steel	LH	5	8	M5	8	28.5	22	10.5	25.0	10.2	9	6.4	-	-
374.06.C.S	Stainless Steel	LH	6	10	M6	10	32.5	25	11.5	30.0	12.5	11	7.5	-	-
374.08.C.S	Stainless Steel	LH	8	13	M8	13	39.5	30	14.0	38.0	16.5	13	9.7	-	-
374.10.C.S	Stainless Steel	LH	10	16	M10	16	47.0	35	15.5	47.5	20.0	16	12.0	-	-
374.12.C.S	Stainless Steel	LH	12	16	M12	16	47.0	35	15.5	47.5	20.0	16	12.0	-	-

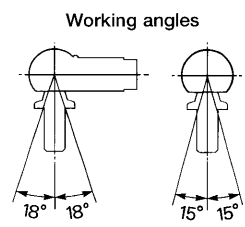
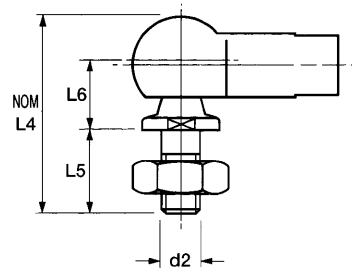
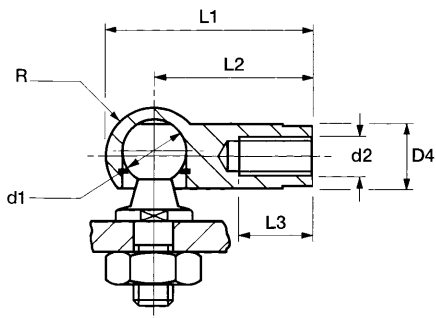

[Try Prime](#)

[Your Amazon.com](#)

[Today's Deals](#)

[Gift Cards](#)

[Sell](#)

[Help](#)

Shop by **Department** ▾

**Search**

Electronics ▾

**Go**

Hello. Sign **Your Account**

**All Electronics**

[Best Sellers](#)

[Electronics Accessories](#)

[Audio & Home Theater](#)

[Camera & Photo](#)

[Car Electronics 8](#)

[Video Games](#) › [PC](#) › [Accessories](#) › [Controllers](#) › [Gamepads](#)



## Logitech Rumblepad 2 Vibration Feedback Gamepad

by [Logitech](#)

[157 customer reviews](#)

| [4 answered questions](#)

**Available from these sellers.**

- Product Type - Gamepad
- Two analog sticks give you a performance edge with smooth 360-degree control

**3 new** from **\$78.42**    **5 used** from **\$20.00**

[Click to open expanded view](#)

There is a newer model of this item:



[Logitech Gamepad F310](#)

**\$19.99**

(614)

**In Stock.**

### Customers Who Viewed This Item Also Viewed

Page 1 of



[Logitech Gamepad F310](#)

(614)

**\$19.99**



[Logitech Gamepad F710](#)

(444)

**\$31.89**



[Logitech Rumble Gamepad F510](#)

(151)

**\$99.99**

### Customers viewing this page may be interested in these sponsored links [\(Wh](#)

• [Mandos de Juego Logitech](#)

**Gamepads Logitech F510 y F310s.** Los mejores pre [www.discoazul.com/mandos-logitech/](http://www.discoazul.com/mandos-logitech/)

• [Vibration Test Equipment](#)

Unholtz-Dickie: Shakers, Amplifiers Sliptables, Contr